

E12L

Parallel mechanism in aluminium for manual folding on one side

Parallel mechanism that moves on nylon-coated ball bearings.

Depending on requirements and/or size, one or two folding extensions can be fitted.

The system extends by pulling out the movable leg; at its full extent the extensions are removed and placed in position.

This mechanism is particularly suitable for large sized tables.

Sliding lock profiles.

Mechanism for movable legs.

A mechanism is available on request complete with legs and customisations.

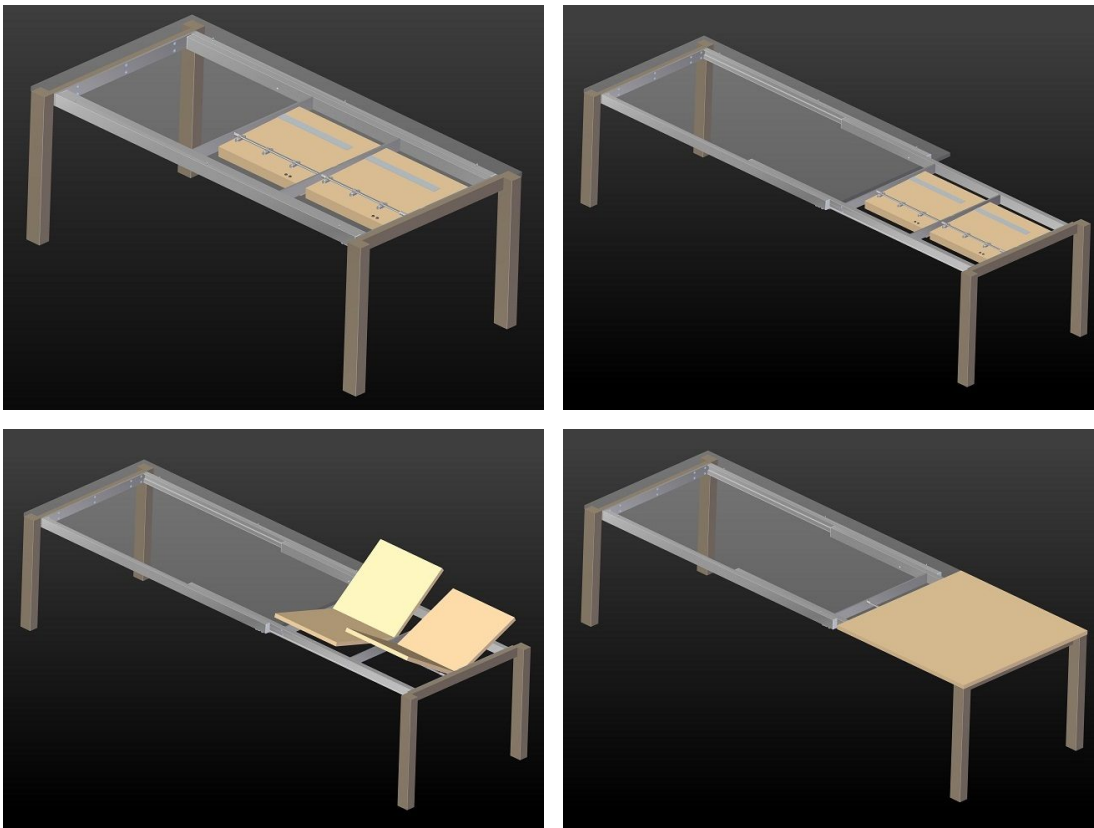

Opening:

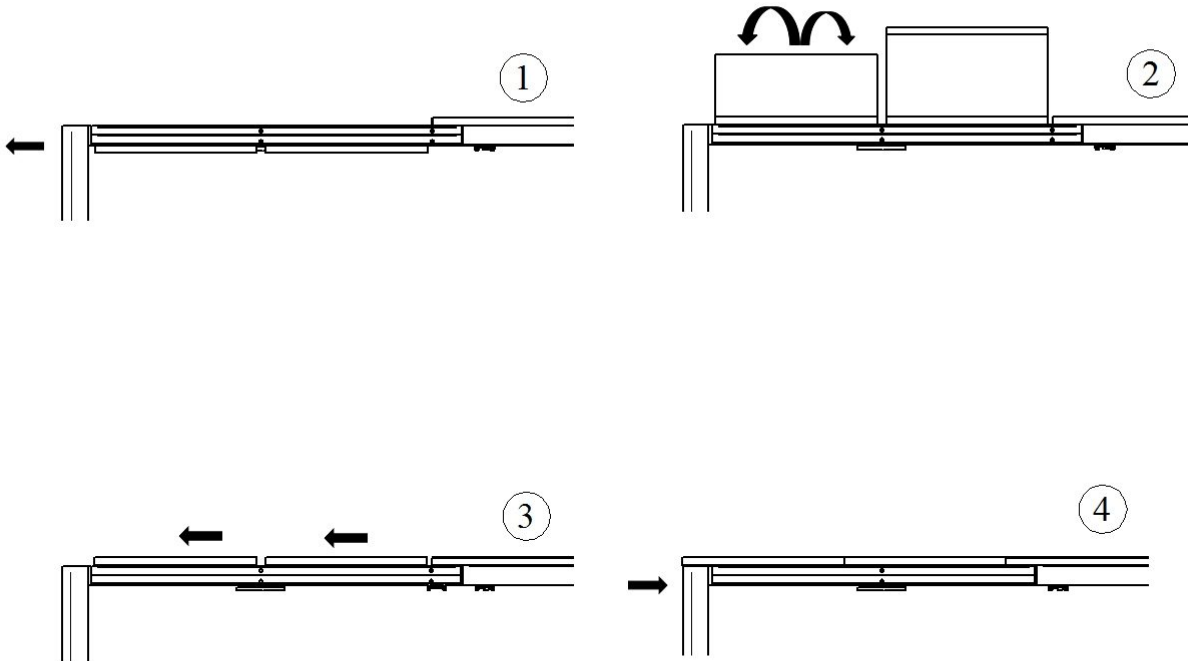

Finishings:



Standard Sizes:

Dimensions (table closed/open)

1000×2000/2500-3000

1000×2500/3100-3700